

UNICAT TerraCross Expedition Body TC41 six

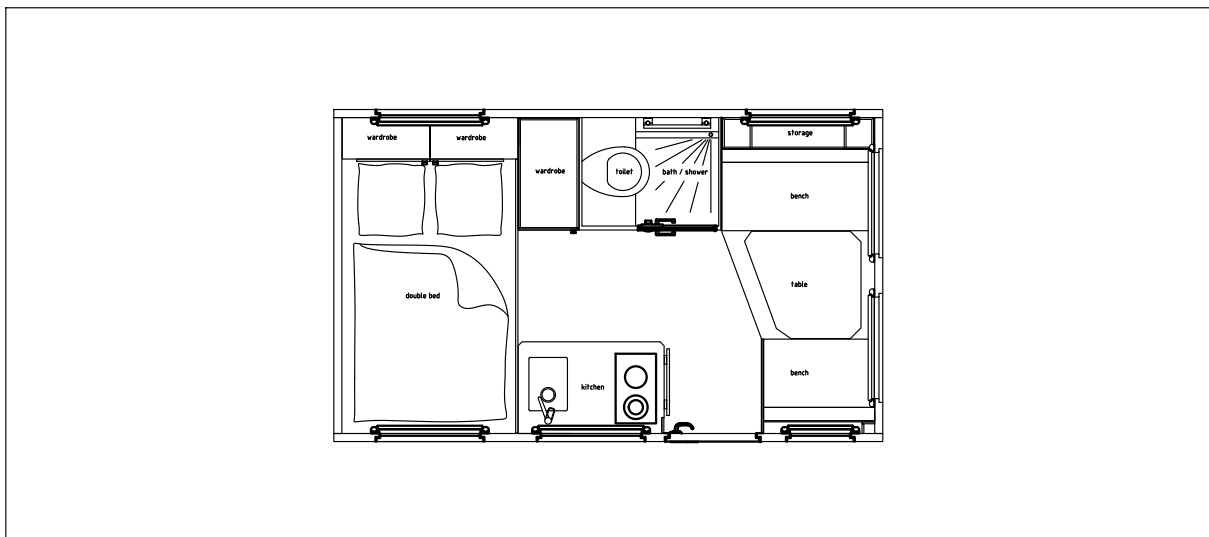

Body dimensions: 4,10 m x 2,48 m x 2,11 m
Seats: 2-3
Beds: Double bed 1,30 m x 2,00 m
Bathroom / Shower: Bathroom combined with toilet and shower
Kitchen: Induction cooker,
fridge with freezer 103 liters cooling, 17 liters freezer
Freshwater: 440 liters
Greywater: 148 liters
Blackwater: 90 liters
Battery capacity: 4 AGM 12 V, 210 Ah, effectively useable energy 5,1 kWh



Body

Outer dimensions of the cabin

- Length 4100 mm (161.4"), width 2480 mm (97.6"), height 2105 mm (82.9")

Inner dimensions of the cabin

- Length 3980 mm (156.7"), width 2360 mm (92.9"), height 1950 mm (76.8")

Body unit construction

- Self supporting UNICAT sandwich plate panels of fiberglass composite
- Wall thickness 60 mm (2.36") with polyurethane foam insulation
- 3 mm (0.12") FRP outer surface, 2 mm (0.08") FRP inner surface
- Insulation rating 0.44 W/m² K (0.078 Btu/ft² hr °F)
- Cold bridge free glued with FRP profiles
- Floor panel with integrated steel frame for bolting of a 3-point subframe
- Additional insulation of the floor

Entrance door and storage compartment doors

- Entrance door with pull-out staircase
- Constructed of fiberglass composite panels and FRP step profiles
- Thickness of doors 60 mm (2.36")
- Internal double seal with combined hollow profile and lip seal
- Anti-theft stainless steel hinges
- Safety lock with latch bolt, dead bolt and additional locks at top and bottom
- Safety cylinder locks all keyed alike

Windows

- Top hinged UNICAT windows with frames made of FRP step profiles
- Double laminated safety glass with insulating space, thickness 21 mm (0,8")
- Internal double seal with combined hollow profile and lip seal
- Anti-theft stainless steel hinges
- Window support and lift system with gas springs, made of stainless steel
- Window locking system, made of stainless steel
- Roller blinds with blackout blind and mosquito net, frame made of aluminium

Roof hatch

- Burglar-proof boat hatch with mosquito net in the bathroom
- Acrylic glass, thickness 12,7 mm (0,5")
- Internal seal with hollow profile

Interior Layout

Seating area

- Seating area for 2-3 persons with swiveling table on pedestal in the front
- Seating area converts to bed, size: 800 mm (31.5") x 2000 mm (78.7")

Beds

- Double bed with suspension, ventilation and heating in the rear
- Comfortable mattress, size: 1300 mm (51.2") x 2000 mm (78.7")

Sanitary room

- Combined bath and shower room with door to isolate from living room
- Porcelain toilet
- Tiled floor with slope and gutter

Kitchen

- Kitchen cabinet with drawers on full extensions with ball bearings
- Worktop, dimensions: 1100 mm (43.3") x 650 mm (25.5")
- Built-in stainless steel sink with stainless steel tap
- 2 zone induction cooker
- Hanger cabinets above the worktop
- Fridge-freezer, 103 liters (27.1 US gal.) cooling, 17 liters (4.5 US gal.) freezer

Storage

- Wardrobe at the bed
- Cabinet with shelves and drawers for Euro-Fix boxes
- Outside storage compartment in the rear under the bed

Workmanship

- All furniture is built to the highest cabinetmaking standard
- Made of plywood with furniture surfaces made of laminate
- Real wood bandings
- Off-Road proven compression fasteners made of stainless steel
- Off-Road proven metal fittings and hinges
- All drawers on full extensions with ball bearings

Layout

- Teak floor
- Walls and ceiling are painted with multiple coats
- Upholstery made of fabric

Technical equipment

Electrical equipment

- 4 AGM batteries 12 V, 210 Ah, effectively usable energy 5,1 kWh
- Control panel for monitoring of DC power and the tank levels
- Main batterie switch and automatic circuit breakers for all DC consumers
- Charging via chassis batteries with DC-DC converter
- Uninterruptible AC power supply by inverter with charger
- Continuous output 3 kW, peak output 6 kW, charging power 0,7 kW
- International charger, 90 - 260 V (45 - 65 Hz), charging power 0,7 kW
- Sockets for AC and USB

Lighting

- LED lights at the entrance, above the table, kitchen, bed and bathroom
- LED gooseneck reading lights dimmable at the seating area and at the bed
- LED strips in the outside storage compartment
- LED flashlight with charging station in the entrance area

Fresh water system

- 2 freshwater tanks with 2 pumps and filters, capacity 440 liters (116.2 US gal.)
- All water installations are located in the frost-proof inside area of the body
- 40 liter (10.5 US gallons) hot water heat exchanger with electric heater
- City water connector
- Outside shower
- Comfortable winterisation system for the fresh water system

Wastewater system

- Wastewater tank capacity: 148 liters (39.0 US gal.)
- All installations are located in the frost-proof inside area of the body
- Lifting pump for the shower
- Pneumatic operated tank evacuation valve, heated
- Discharge operated from the cab and body

Toilet system

- Porcelain toilet with water flushing
- Holding tank capacity: 90 liters (23.7 US gal.)
- All installations are located in the frost-proof inside area of the body
- Vacuum tank ventilation with activated carbon filter
- Pneumatic operated tank evacuation valve, heated
- Discharge operated from the cab and body

Heating system

- Central heating system (9,0 kW) for diesel fuel with height adjustment
- Radiator in the seating area
- Towel radiator in the bathroom
- Bed heating under the mattress
- Heat exchanger in the rear storage compartment
- Antifrost system

Options

Body

- Slanted front of body for better aerodynamics and appearance
- Passage way to drivers cab with lockable door panel
- Entrance door with staircase and fold-out steps
- Central locking system with remote control
- Mosquito net for entrance door
- Roof hatch
- Fixed windows in front
- Spare wheel rack at the rear
- Motorcycle rack
- Bike rack
- Special painting
- Further options on request

Interior layout

- Folding kitchen countertop
- Off-Road proven separation for tableware, cookware and kitchen appliances
- Folding washbasin above the toilette
- Overhead cupboards in bed area
- Upholstery made of ALCANTARA or leather
- Safe
- Further options on request

Technical equipment

- 8 LiFeYPO₄ cells 12,8 V, 200 Ah, effectively usable energy 16,4 kWh
- Solar power system
- Arctic package with additional radiator
- Floor heating in the bathroom
- Air conditioning
- Roof fan in the kitchen
- Drinking water disinfection system
- TV
- Further options on request

